

VDI SAFETY

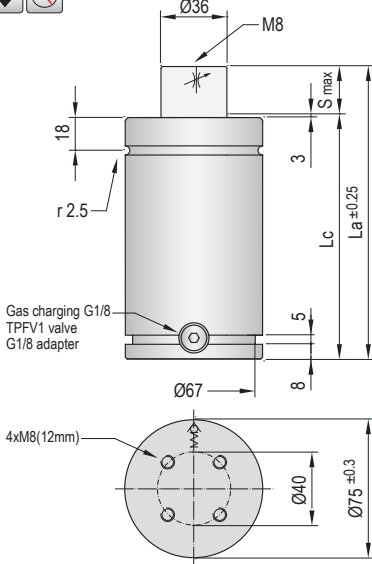

**i** Pressure medium **Nitrogen (N<sub>2</sub>)**

|                               |                       |
|-------------------------------|-----------------------|
| Max. charging pressure        | 150 Bar               |
| Min. charging pressure        | 35 Bar                |
| Rod seal area                 | 10,18 cm <sup>2</sup> |
| Operating temperature         | 0°C - 80°C            |
| Force increase by temperature | 0,33 %/°C             |
| Max. stem speed               | 15 m/min              |
| Maintenance kit               | Kit SR1500            |
| Recommended max. strokes/min  | 5 - 20 spm            |

ISO  
STANDARD  
DIMENSIONS

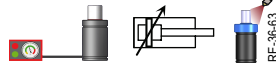

### Required data

|                            |         |
|----------------------------|---------|
| Working stroke             | (mm)    |
| Press speed                | (m/min) |
| Maximum production rate    | (spm)   |
| Gas spring expansion speed | (m/min) |



| Code          | Smax mm | La mm | Lc mm | Fa daN             | 90% F daN | 100% Fc daN | P Bar         | V l   | Kg   |
|---------------|---------|-------|-------|--------------------|-----------|-------------|---------------|-------|------|
| TPSR 1500x13  | 12,7    | 135,4 | 122,7 | 1500 ±5%<br>(20°C) | 1890      | 1940        | 150<br>(20°C) | 0,058 | 3,15 |
| TPSR 1500x25  | 25      | 160   | 135   |                    | 1985      | 2055        |               | 0,095 | 3,30 |
| TPSR 1500x38  | 38      | 186   | 148   |                    | 2025      | 2110        |               | 0,136 | 3,50 |
| TPSR 1500x50  | 50      | 210   | 160   |                    | 2050      | 2135        |               | 0,173 | 3,65 |
| TPSR 1500x63  | 63      | 237   | 174   |                    | 2075      | 2165        |               | 0,210 | 3,90 |
| TPSR 1500x80  | 80      | 270   | 190   |                    | 2085      | 2180        |               | 0,263 | 4,45 |
| TPSR 1500x100 | 100     | 310   | 210   |                    | 2095      | 2190        |               | 0,326 | 4,80 |
| TPSR 1500x125 | 125     | 360   | 235   |                    | 2055      | 2145        |               | 0,429 | 5,36 |

(Other strokes under order)

Force/stroke ratio

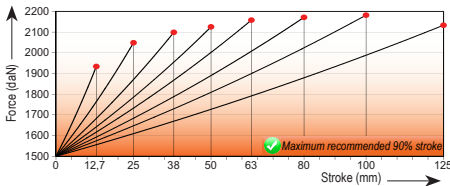

Initial force/charging pressure ratio

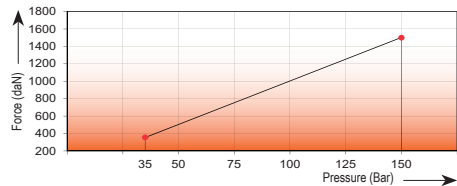

### Assembly possibilities



DROP-IN



SCREWS

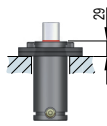

FS 75-FSC 75



FP 75-FPR 75



FB 75

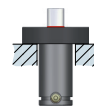

FRS 75

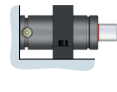

FI 75-FI 75/1